

THE QUARTERLY NEWSLETTER OF THE EMSWORTH RESIDENTS ASSOCIATION

Vol 31 Number 3

www.emsworthresidents.co.uk

July 2008

Oak Park Hospital

At last we have some clear indication of what the new Community Hospital at Oak Park in Havant will look like and what it will contain. There are many good features in the plans but also some things which are less than ideal. The site lies to the east of Petersfield Road and south of Crossland Drive in Havant.

Travel

Access is certainly better than at Havant War Memorial Hospital but car drivers will need to enter the site through a residential area causing considerable congestion throughout the day. The projected 25,000 outpatient attendances a year works out at an average of 100 a day. Are the public transport plans really adequate given the limited parking spaces proposed? Who will pay for the proposed shuttle bus service, given that the majority of patients and visitors will be elderly and bus-pass users, thus making it uneconomic for private operators without subsidies?

Capacity and Consultation

At formal NHS consultations on the plans considered in 2004, the number of beds was proposed as around 120. However, since then the number has been reduced to 49. There has been no public consultation on this change. The current series of manned exhibitions do not equate to public consultation required by Section 11 of the Health and Social Care Act 2001. The exhibition held in Emsworth Community Centre at the beginning of June was very poorly publicised and therefore poorly attended.

Evidence has not been provided of how the capacity will relate to increased population and the currently proposed downgrading of St Richard's Hospital. The plans rely on Care in the Community for which we have no independent monitoring of patient satisfaction. Reliable sources have told me of cases of lone elderly patients being discharged straight from the hospital ward into a cold house without even basic supplies like milk and bread.

Elderly Rehabilitation

The proposals have 25 beds allocated to GPs and 24 beds allocated to Elderly Mental Health. In the original plans, the need for Elderly Rehabilitation beds was also identified but these went along with the EMH in 2006. Elderly Rehabilitation patients are at present being sent to Selsey or Petersfield, we have been offered Cosham – not an easy bus route from Emsworth. This is a ludicrous state of affairs bearing in mind the fact that a key part of recovery is to have family and friends able to visit. Such a journey is often an impossibility for elderly relatives.

See Oak Park Hospital Sustainability on page 4 *Richard Jannaway*

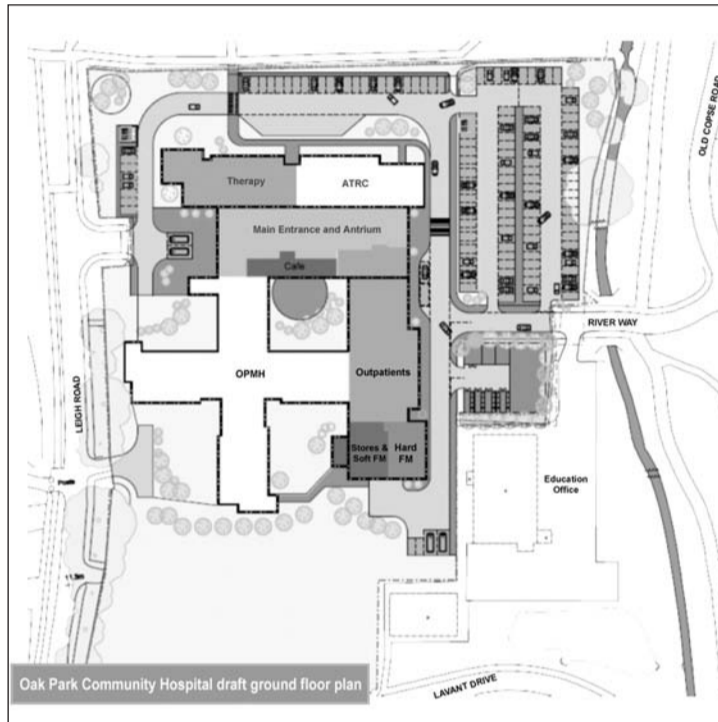

Local Boy Achieves

South East Hampshire Under 13's Bowling Champion 2007/8. A close finish at the top of bowling in the South East Hampshire Indoor



League, four cricketers in contention, one wicket needed to claim top bowler. James Christian of Emsworth, strode to the crease for his penultimate over of the season. His slow but accurate spin pitched short, tempting the batsman to hit for six, without the pace to make the distance, he was caught giving James the sole wicket needed for the top spot. James finished off his first indoor season with a maiden over and the U13 South East Hampshire Indoor Bowler of the Year Award for 2007/8.

Selected for the SEH representative VI to play against Fareham & Crofton, League Champions, on presentation night, James went on to take a further two wickets with his first two balls. And his excellent fielding skills took the bails off, for a run out, to take a third wicket and seal his well deserved achievement.

Well done and congratulations!

Submitted by James' father

Two Regional Business Personalities in one small town - Emsworth!

There must be something about Emsworth with two well known faces in the town, Lulu Bowerman and Amanda Thomas, receiving awards.



Lulu Bowerman (left) and Amanda Thomas with their awards

Lulu Bowerman became 'The News' Business Personality of the Year in January for her work as Chairman of the Emsworth Food Festival. Chair for three years, she has worked tirelessly with the committee and band of volunteers to develop the event, seeing it become one of the largest food events in the country and attracting over 55,000 visitors. However, with success has come disruption to local life over the weekend, and the decision to postpone the event until 2009 is providing Lulu and the committee with the time to work with local businesses and residents to address the future of the Food Festival and ensure it continues to meet its original objectives.

In March, Amanda Thomas was awarded Business Personality of the Year by Chichester Observer for her two roles as General Manager of The Brookfield Hotel and as Treasurer of the Emsworth Business Association. Working at the Brookfield Hotel for over 20 years, Amanda has proved to be a driving force and mentor, ensuring the highest levels of customer service combined with great team motivational skills – so strong that the majority of the team have stayed with her throughout the years.

Amanda Fallbrow

Emsworth Trees Exhibition

The Rudkin Room at Emsworth Museum was filled to overflowing on Saturday 31 May for the opening of "Emsworth Trees" by Brendan Gibb-Gray, local councillor and a man passionate about trees. Amongst other things, he told us that his father had planted a stand of Willow and Mountain Ash outside a factory beside the old Portsmouth Airfield. The factory is no longer there but the trees are! He reminded us that there is a net loss of trees every year and we should be planting two trees for every one felled in order to counteract this deficit.

The exhibition celebrated the trees in our streets, public spaces, woodland and gardens and took a fascinating look at the history of trees in Emsworth and when and why they were planted. It also looked at what is happening currently, what we must do to preserve the trees we have and what to plant for the future. The interdependence between people and their environment was stressed and the tension that can arise when development proposals conflict with trees was not ignored. Changing climate means that trees should be included in new developments to provide shade, as well as being beautiful in their own right.

Impressive panels designed by Brian Picknett and illustrated with wonderful photographs of some of Emsworth's many splendid trees formed the backbone of the display. Articles made from English wood, ranging from ornamental pieces (made by Solent Guild of Woodcarvers and Sculptors and Zen Furniture Workshop) to bows and arrows and firesticks (made by John Green and Jonathon Huet) were also on show.

Organised by Emsworth Tree Wardens, the exhibition explained the work of the Tree Council and looked at what Tree Wardens do and don't do. Copies of the recently published Emsworth Town Centre Tree Trail booklet were on sale.

Local sponsorship from The Wren Centre, Catering and Leisure Supplies Ltd, Couzens & Son (Builders) and Henry Adams, estate agents enabled all this to take place and Emsworth Tree Wardens are grateful for their support.

If you didn't manage to get to the Museum to see this exhibition during June, you might like to know that it is going to be in the foyer of Havant Borough Council Offices in July. Later on in the year, it will be on show in the Pastoral Centre in the Square.

Ann Jolly



Some of the Emsworth Tree Wardens at the opening: Clockwise from back left: Ann Jolly (secretary); Brendan Gibb-Gray; Jonathon Huet; Ian Chilver; Richard Galloway (treasurer); Margaret Gibb-Gray and Frances Jannaway (chair).



Trees

Trees are the best monuments that a man can erect to his own memory. They speak his praises without flattery, and they are blessings to children yet unborn. Lord Orrery, 1749

Contents

	Page
Letters & Editorial	2
ERA, EBA, ECB & Council News	3
Emsworth Design Statement	3
Local News	4
Memorial Garden Special	5
Getting around in Emsworth Special Feature	6/7
Environment	8
Community News	9
Events Diary	10
Groups & Societies	11
ERA committee	12
Community Organisations	12

... And lots more